

COMUNE DI BAISO  
Provincia di Reggio Emilia

**BAI 58**

**CENTROGEO SURVEY SNC**

*42015 Correggio (RE) - Piazza S. Quirino, 6 - tel 0522/641001 - Fax: 632162*

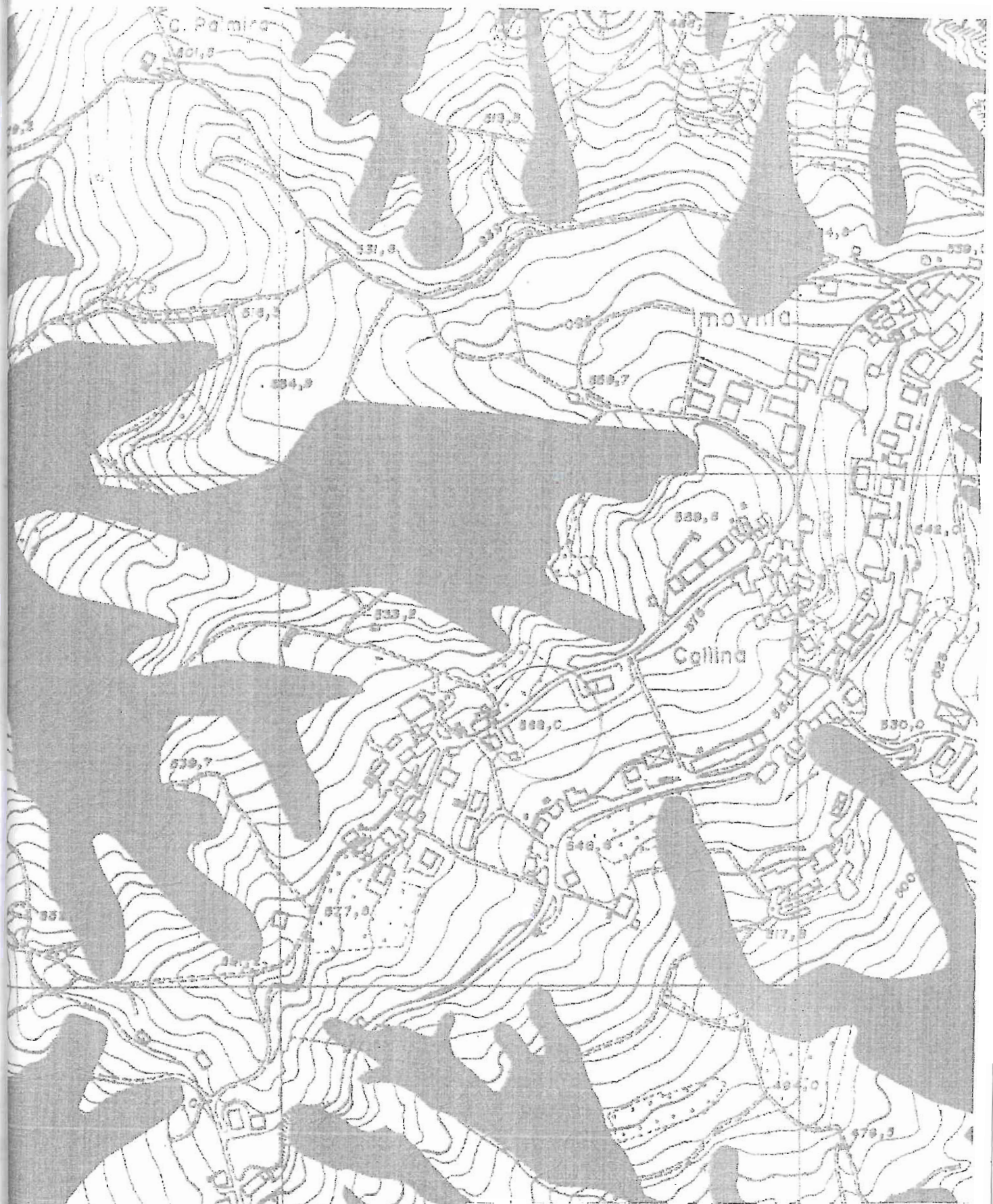

ESTRATTO DELLA CARTA INVENTARIO DEL DISSESTO

SCALA 1 : 5.000

LEGENDA



*Frana attiva (a1)*



*Frana quiescente (a2)*



**ESTRATTO DI MAPPA CATASTALE  
IN SCALA 1 : 2.000**



BICAZIONE PROVE LOC. COLLINA, BAISO

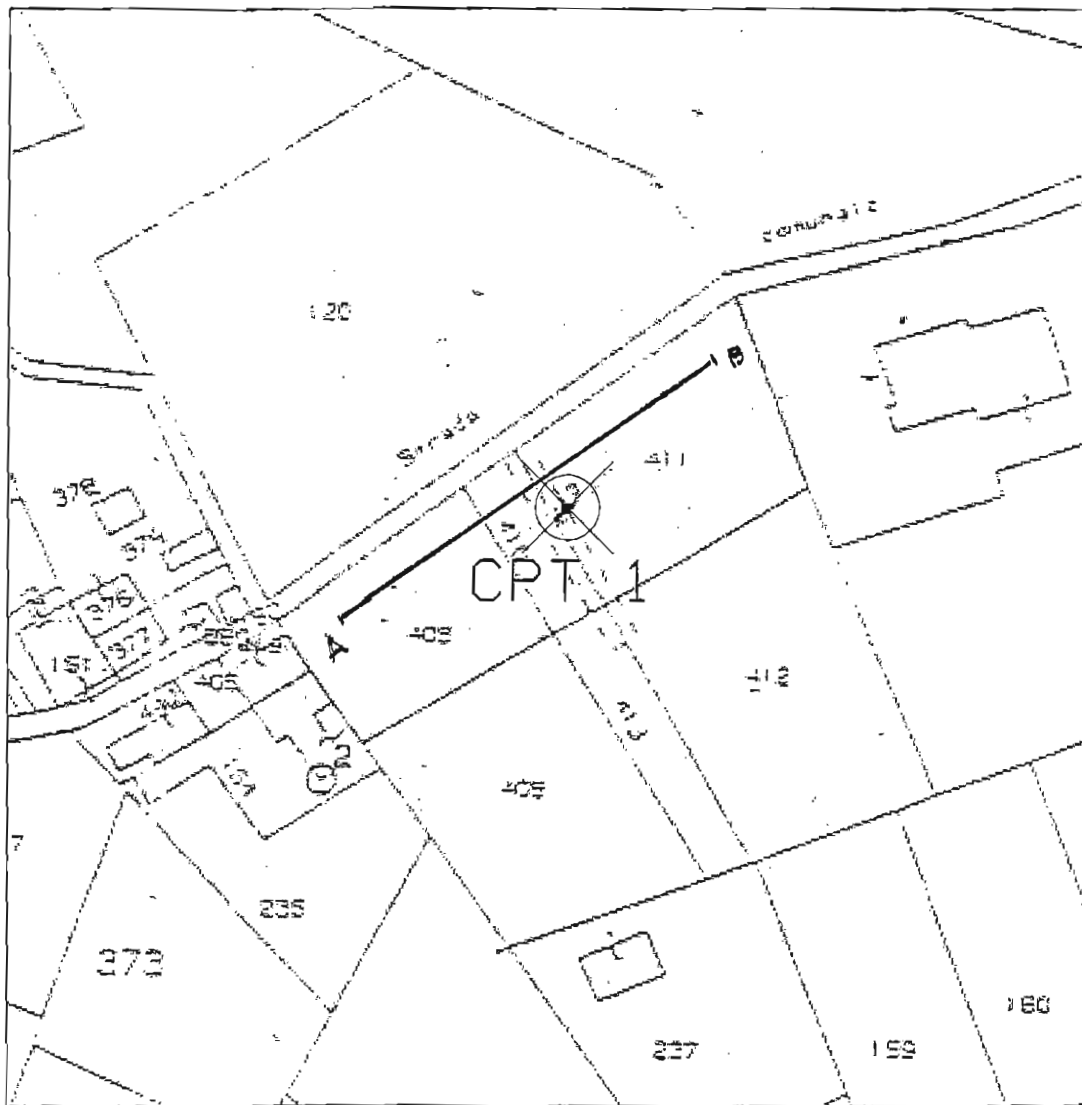

**PROVA PENETROMETRICA STATICA  
LETTURE DI CAMPAGNA / VALORI DI RESISTENZA**

**CPT 1**

3.010496-121

- committente: Dott. Geol. Bonvicini Andrea Camillo  
- lavoro: Prove penetrometriche statiche  
- località: Località Collina, Baiso (RE)  
- resp. cantiere:  
- assist. cantiere:

- data prova : 21/04/2006  
- quota inizio : Piano Campagna  
- prof. falda : Falda non rilevata  
- data emiss. : 21/04/2006

prf	LP	LL	Rp	RL	Rp/RI	prf	LP	LL	Rp	RL	Rp/RI
m	Kg/cm <sup>2</sup>	Kg/cm <sup>2</sup>	Kg/cm <sup>2</sup>	Kg/cm <sup>2</sup>	-	m	Kg/cm <sup>2</sup>	Kg/cm <sup>2</sup>	Kg/cm <sup>2</sup>	Kg/cm <sup>2</sup>	-
0,20	10,0	16,0	10,0	0,60	17,0	2,80	34,0	84,0	34,0	1,53	22,0
0,40	10,0	19,0	10,0	0,80	12,0	3,00	83,0	106,0	83,0	3,80	22,0
0,60	10,0	22,0	10,0	1,20	8,0	3,20	32,0	89,0	32,0	3,27	10,0
0,80	12,0	30,0	12,0	1,53	8,0	3,40	37,0	86,0	37,0	3,13	12,0
1,00	29,0	52,0	29,0	1,73	17,0	3,60	39,0	86,0	39,0	3,40	11,0
1,20	22,0	48,0	22,0	1,67	13,0	3,80	41,0	92,0	41,0	3,73	11,0
1,40	24,0	49,0	24,0	1,67	14,0	4,00	32,0	88,0	32,0	4,27	7,0
1,60	38,0	63,0	38,0	4,60	8,0	4,20	24,0	88,0	24,0	2,87	8,0
1,80	27,0	96,0	27,0	3,53	8,0	4,40	28,0	71,0	28,0	2,80	10,0
2,00	34,0	87,0	34,0	2,80	12,0	4,60	34,0	76,0	34,0	4,73	7,0
2,20	62,0	104,0	62,0	2,73	23,0	4,80	49,0	120,0	49,0	4,87	10,0
2,40	68,0	109,0	68,0	2,27	30,0	5,00	114,0	187,0	114,0	---	---
2,60	38,0	72,0	38,0	3,33	11,0						

- PENETROMETRO STATICO tipo da 20 t - (senza anello allargatore) -  
- COSTANTE DI TRASFORMAZIONE Ct = 10 - Velocità Avanzamento punta 2 cm/s  
- punta meccanica tipo Begemann ø = 35.7 mm (area punta 10 cm<sup>2</sup> - apertura 60°)  
- manicotto laterale (superficie 150 cm<sup>2</sup>)

**PROVA PENETROMETRICA STATICA  
DIAGRAMMA DI RESISTENZA**

**CPT 1**

3.010496-121

- committente: Dott. Geol. Bonvicini Andrea Camillo  
 - lavoro: Prove penetrometriche statiche  
 - località: Località Collina, Baiso (RE)  
 - resp. cantiere:  
 - assist. cantiere:

- data prova : 21/04/2006  
 - quota inizio : Piano Campagna  
 - prof. falda : Falda non rilevata  
 - scala vert.: 1 : 100  
 - data emiss. : 21/04/2006

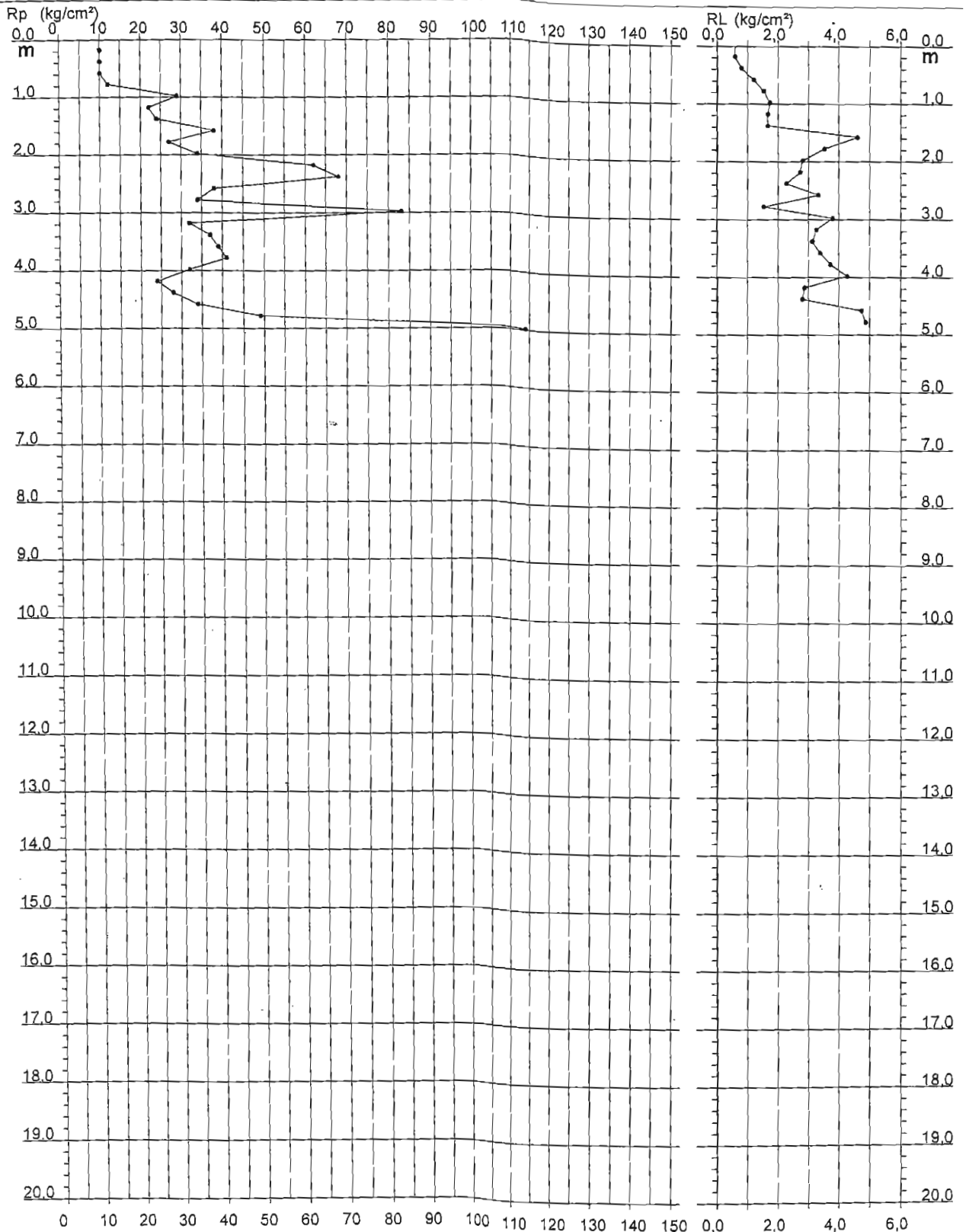

# sezione sismica Baiso

## PROFONDITA' RIFRATTORI

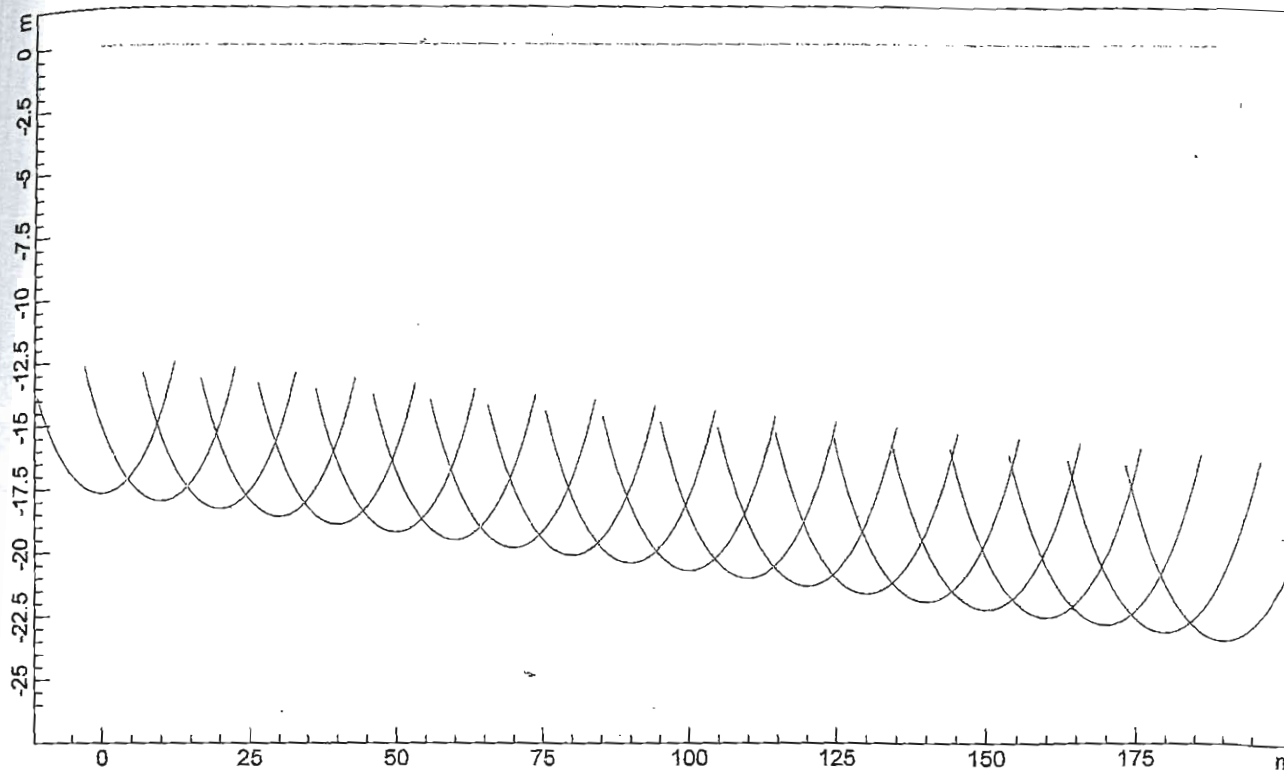

## SEZIONE VERTICALE

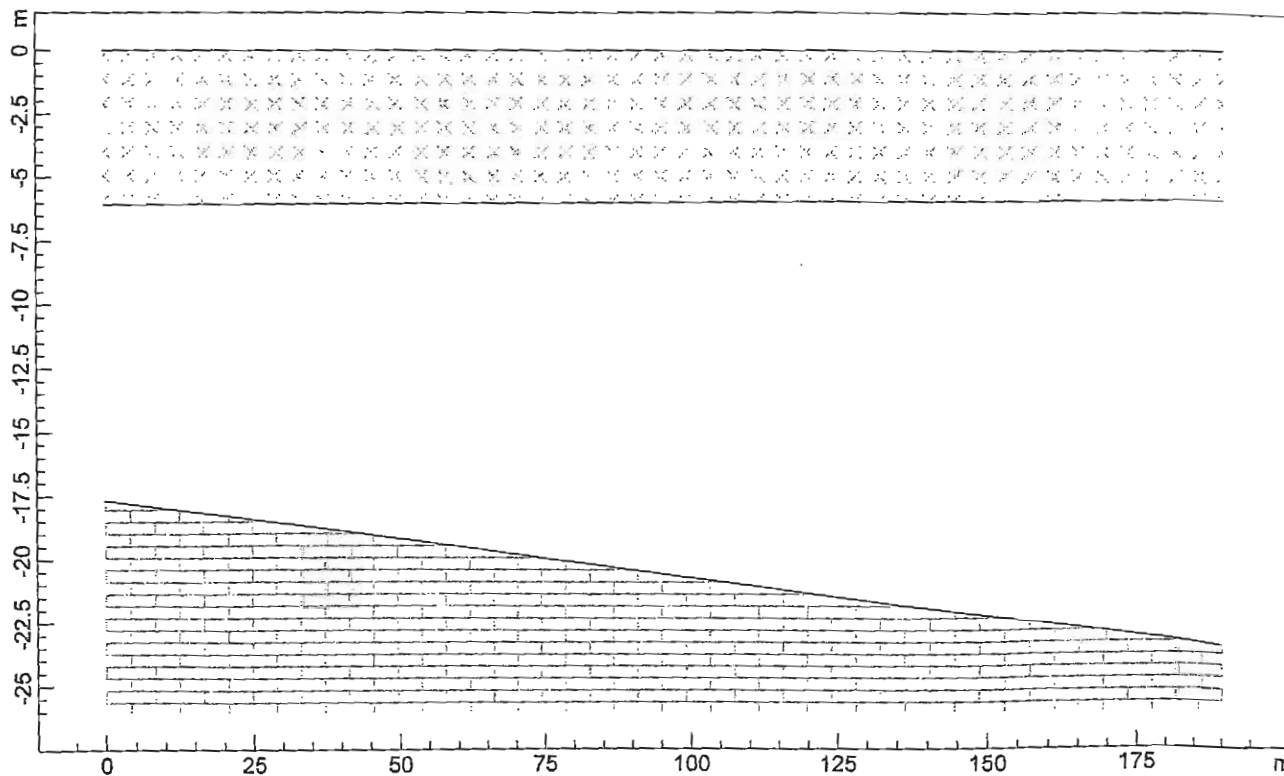

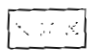
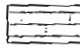
 331.9 m/s     1364.5 m/s     3331.1 m/s

# sezione sismica Baiso

## DROMOCRONE ORIGINALI

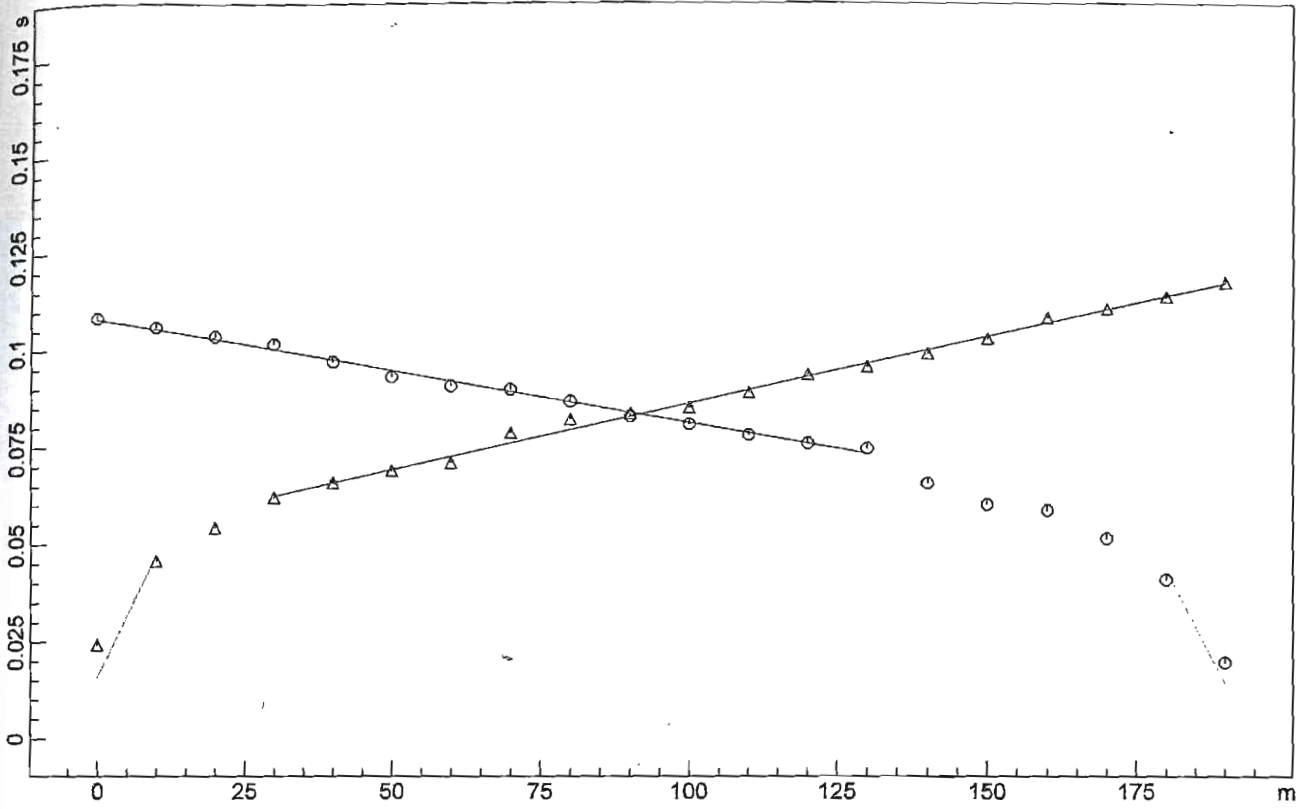

## DROMOCRONE TRASLATE

