

COMUNE DI BAISO  
Provincia di Reggio Emilia

**BAI 60**

**CENTROGEO SURVEY SNC**

*42015 Correggio (RE) - Piazza S. Quirino, 6 - tel 0522/641001 - Fax: 632162*

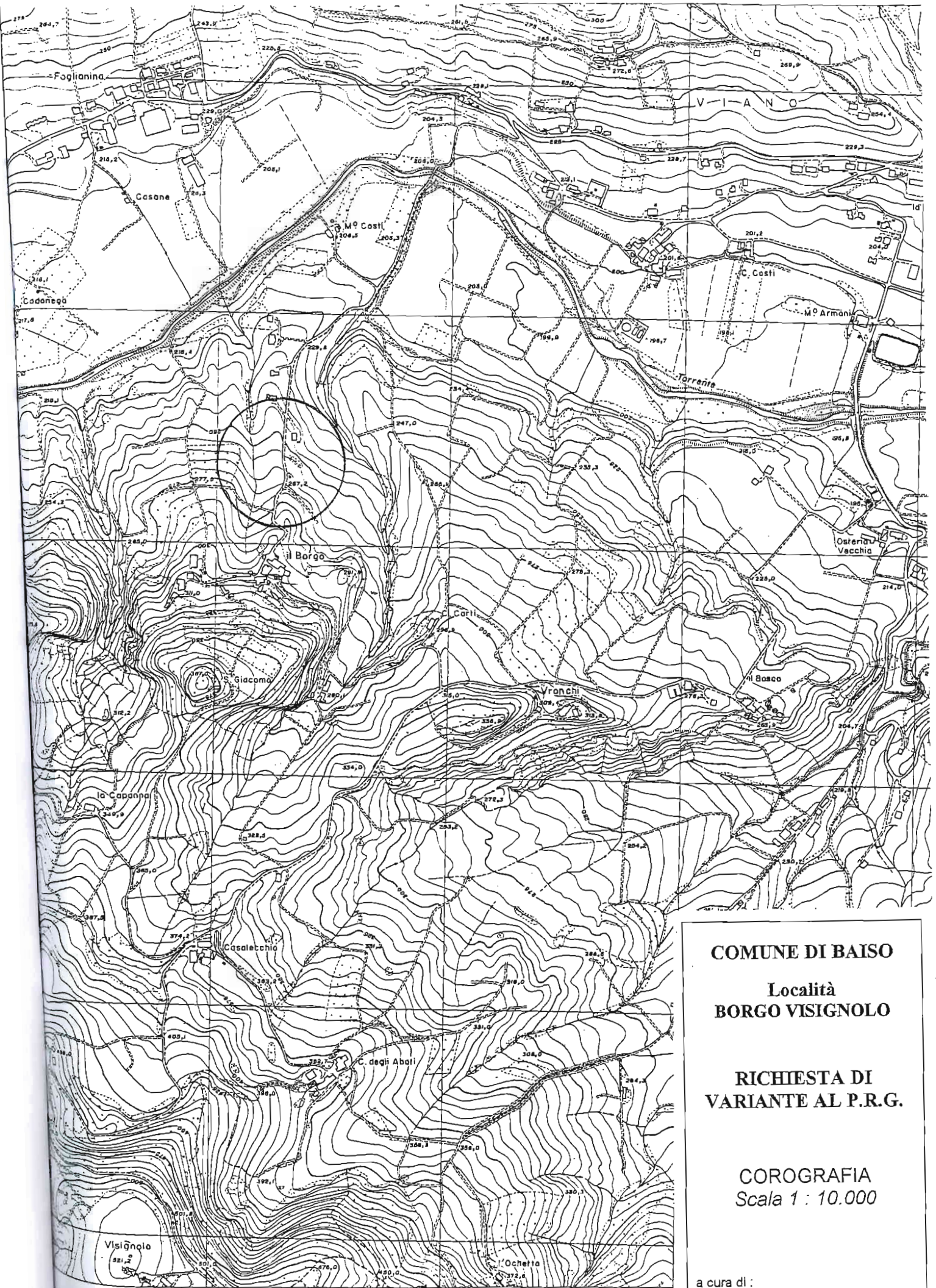

**COMUNE DI BAISO**

**Località  
BORGO VISIGNOLO**

**RICHIESTA DI  
VARIANTE AL P.R.G.**

**COROGRAFIA  
Scala 1 : 10.000**

a cura di:  
Dott. Geol. Andrea C. Bonvicini

# Planimetria Catastale

365

22,31

25,00

363<sup>93</sup>

Strada

Area Residenziale  
di Completamento  
mq. 800,00

20,57

362

20,42

CPT<sub>2</sub>

364

21,23

21,1

CPT<sub>1</sub>

17,76

15,27

Scala 1:500

**PLANIMETRIA  
CON UBICAZIONE DELLE PROVE  
PENETROMETRICHE**



**PROVA PENETROMETRICA STATICA  
 LETTURE DI CAMPAGNA / VALORI DI RESISTENZA**

**CPT 1**

3.010496-121

- committente:	Sig. GRASSI Gianfranco	- data prova :	10/03/2003
- lavoro:	Prove penetrometriche statiche	- quota inizio :	Piano Campagna
- località:	Borgo Visignolo Baiso (RE)	- prof. falda :	Falda non rilevata
- resp. cantiere:		- data emiss. :	08/04/2005
- assist. cantiere:			

prf	LP	LL	Rp	RL	Rp/RI	prf	LP	LL	Rp	RL	Rp/RI
m	Kg/cm <sup>2</sup>	Kg/cm <sup>2</sup>	Kg/cm <sup>2</sup>	Kg/cm <sup>2</sup>	-	m	Kg/cm <sup>2</sup>	Kg/cm <sup>2</sup>	Kg/cm <sup>2</sup>	Kg/cm <sup>2</sup>	-
0,20	8,0	17,0	8,0	0,60	13,0	2,20	54,0	127,0	54,0	1,60	34,0
0,40	8,0	17,0	8,0	0,87	9,0	2,40	91,0	115,0	91,0	3,67	25,0
0,60	8,0	21,0	8,0	0,67	12,0	2,60	65,0	120,0	65,0	3,53	18,0
0,80	11,0	21,0	11,0	0,60	18,0	2,80	67,0	120,0	67,0	6,00	11,0
1,00	14,0	23,0	14,0	0,60	23,0	3,00	60,0	150,0	60,0	2,67	22,0
1,20	12,0	21,0	12,0	0,60	20,0	3,20	140,0	180,0	140,0	8,00	18,0
1,40	13,0	22,0	13,0	0,80	16,0	3,40	150,0	270,0	150,0	8,00	19,0
1,60	16,0	28,0	16,0	1,27	13,0	3,60	200,0	320,0	200,0	9,33	21,0
1,80	14,0	33,0	14,0	5,40	3,0	3,80	230,0	370,0	230,0	10,00	23,0
2,00	69,0	150,0	69,0	4,87	14,0	4,00	200,0	350,0	200,0	—	—

- PENETROMETRO STATICO tipo da 10 t - (con anello allargatore) -
- COSTANTE DI TRASFORMAZIONE Ct = 10 - Velocità Avanzamento punta 2 cm/s
- punta meccanica tipo Begemann ø = 35.7 mm (area punta 10 cm<sup>2</sup> - apertura 60°)
- manicotto laterale (superficie 150 cm<sup>2</sup>)

**PROVA PENETROMETRICA STATICA  
DIAGRAMMA DI RESISTENZA**

**CPT 1**

3.010496-121

- committente: Sig. GRASSI Gianfranco  
- lavoro: Prove penetrometriche statiche  
- località: Borgo Visignolo Baiso (RE)  
- resp. cantiere:  
- assist. cantiere:

- data prova : 10/03/2003  
- quota inizio : Piano Campagna  
- prof. falda : Falda non rilevata  
- scala vert.: 1 : 100  
- data emiss. : 08/04/2005

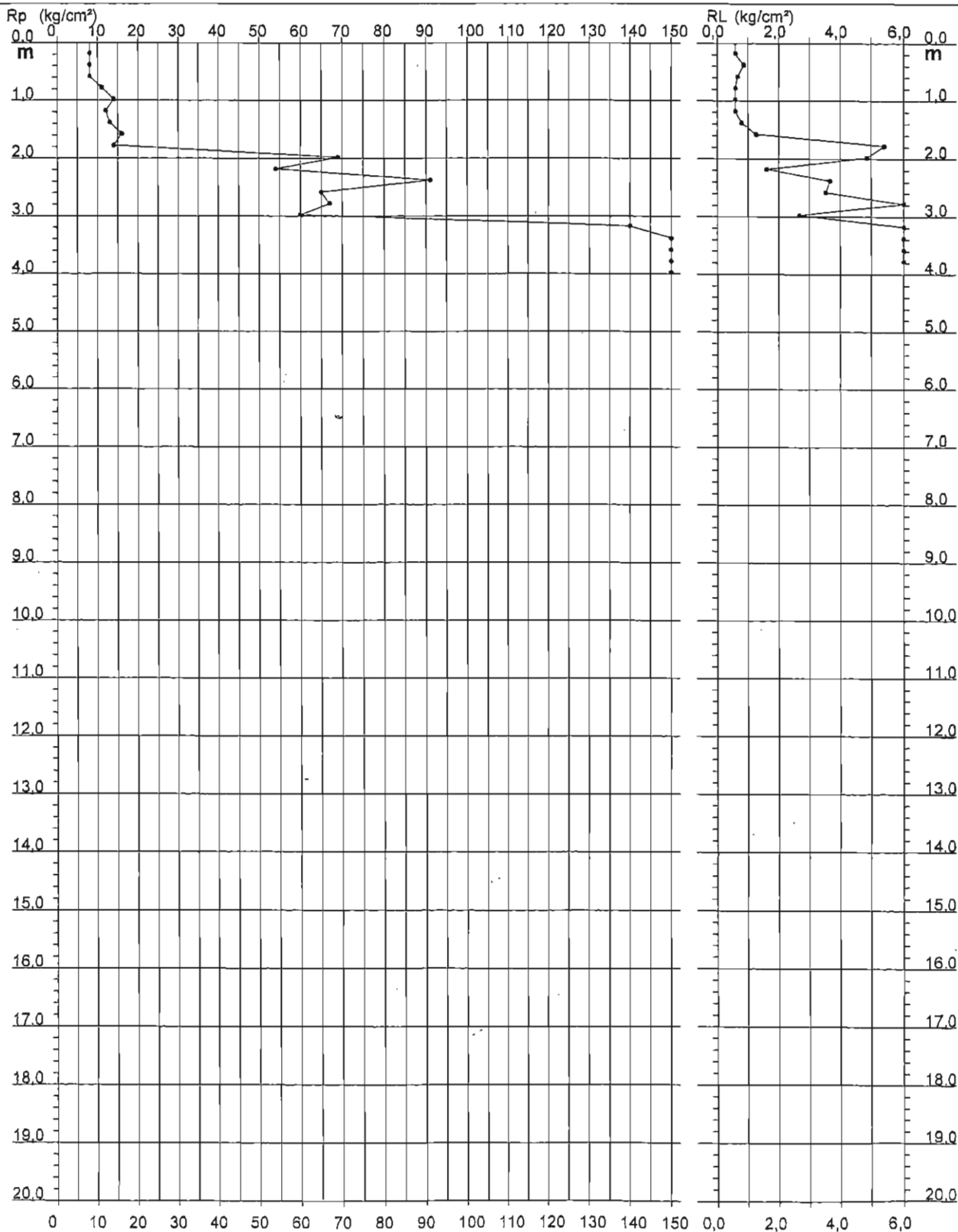

**PROVA PENETROMETRICA STATICA  
LETTURE DI CAMPAGNA / VALORI DI RESISTENZA**

**CPT 2**

3.010496-121

- committente:	Co.Imm. srl	- data prova :	05/04/2005
- lavoro:	Prove penetrometriche statiche	- quota inizio :	Piano Campagna
- località:	Via Borgo Visignolo, Baiso (RE)	- prof. falda :	Falda non rilevata
- resp. cantiere:		- data emiss. :	06/04/2005
- assist. cantiere:			

prf	LP	LL	Rp	RL	Rp/RI	prf	LP	LL	Rp	RL	Rp/RI
m	Kg/cm <sup>2</sup>	Kg/cm <sup>2</sup>	Kg/cm <sup>2</sup>	Kg/cm <sup>2</sup>	-	m	Kg/cm <sup>2</sup>	Kg/cm <sup>2</sup>	Kg/cm <sup>2</sup>	Kg/cm <sup>2</sup>	-
0,20	9,0	10,0	9,0	0,87	10,0	2,20	17,0	36,0	17,0	2,27	8,0
0,40	11,0	24,0	11,0	0,73	15,0	2,40	70,0	104,0	70,0	2,00	35,0
0,60	11,0	22,0	11,0	1,20	9,0	2,60	51,0	81,0	51,0	3,20	16,0
0,80	14,0	32,0	14,0	1,13	12,0	2,80	34,0	82,0	34,0	3,27	10,0
1,00	11,0	28,0	11,0	1,47	7,0	3,00	37,0	86,0	37,0	3,07	12,0
1,20	11,0	33,0	11,0	1,07	10,0	3,20	35,0	81,0	35,0	2,80	13,0
1,40	12,0	28,0	12,0	1,13	11,0	3,40	54,0	96,0	54,0	3,13	17,0
1,60	15,0	32,0	15,0	1,20	12,0	3,60	70,0	117,0	70,0	7,87	9,0
1,80	13,0	31,0	13,0	1,07	12,0	3,80	47,0	165,0	47,0	---	---
2,00	15,0	31,0	15,0	1,27	12,0						

- PENETROMETRO STATICO tipo da 20 t - (senza anello allargatore) -
- COSTANTE DI TRASFORMAZIONE Ct = 10 - Velocità Avanzamento punta 2 cm/s
- punta meccanica tipo Begemann ø = 35.7 mm (area punta 10 cm<sup>2</sup> - apertura 60°)
- manicotto laterale (superficie 150 cm<sup>2</sup>)

**PROVA PENETROMETRICA STATICA  
DIAGRAMMA DI RESISTENZA**

**CPT 2**

3.010496-121

- committente: Co.Imm. srl  
- lavoro: Prove penetrometriche statiche  
- località: Via Borgo Visignolo, Baiso (RE)  
- resp. cantiere:  
- assist. cantiere:

- data prova : 05/04/2005  
- quota inizio : Piano Campagna  
- prof. falda : Falda non rilevata  
- scala vert.: 1 : 100  
- data emiss. : 06/04/2005

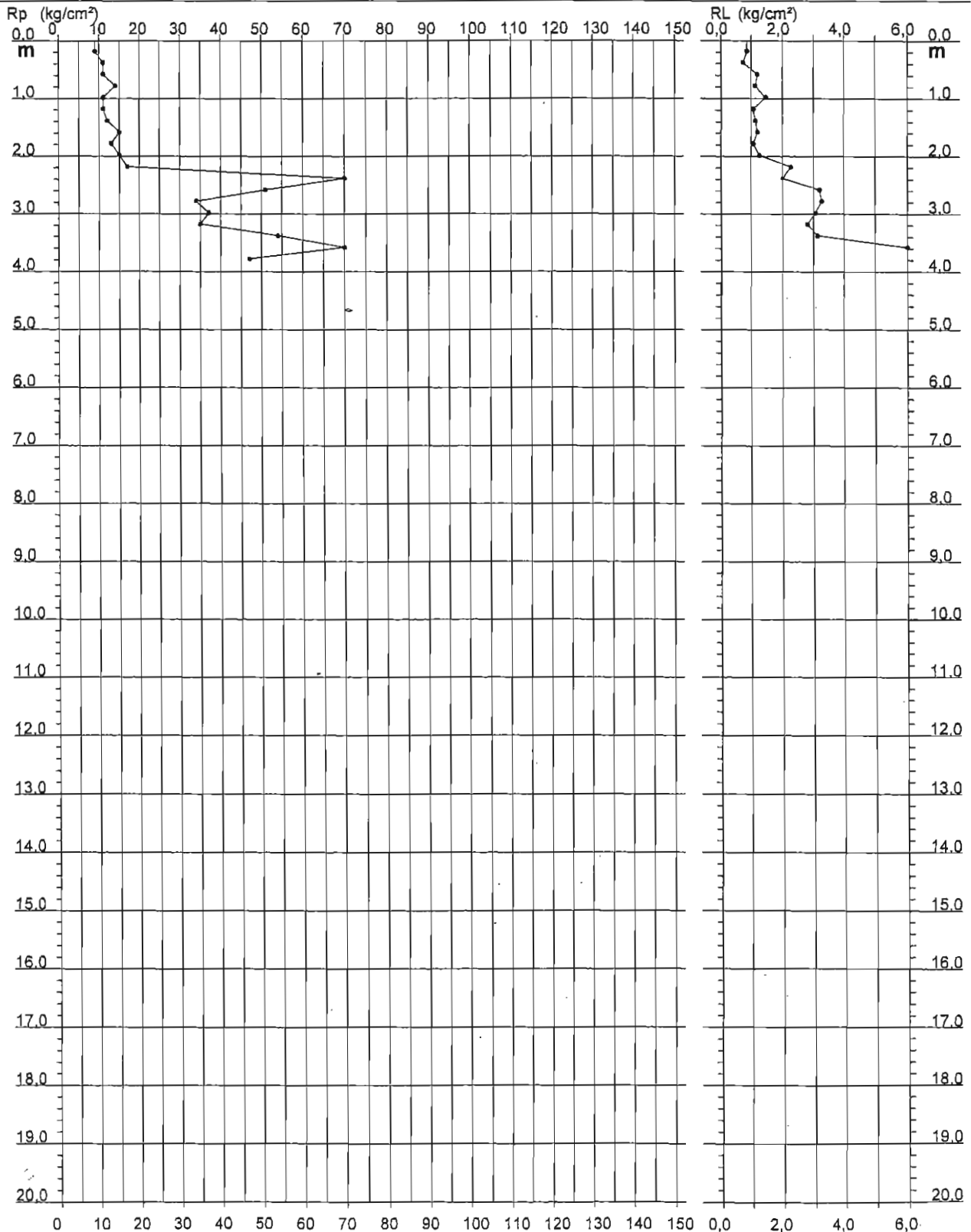

Planimetria Catastale

Scala 1:2000

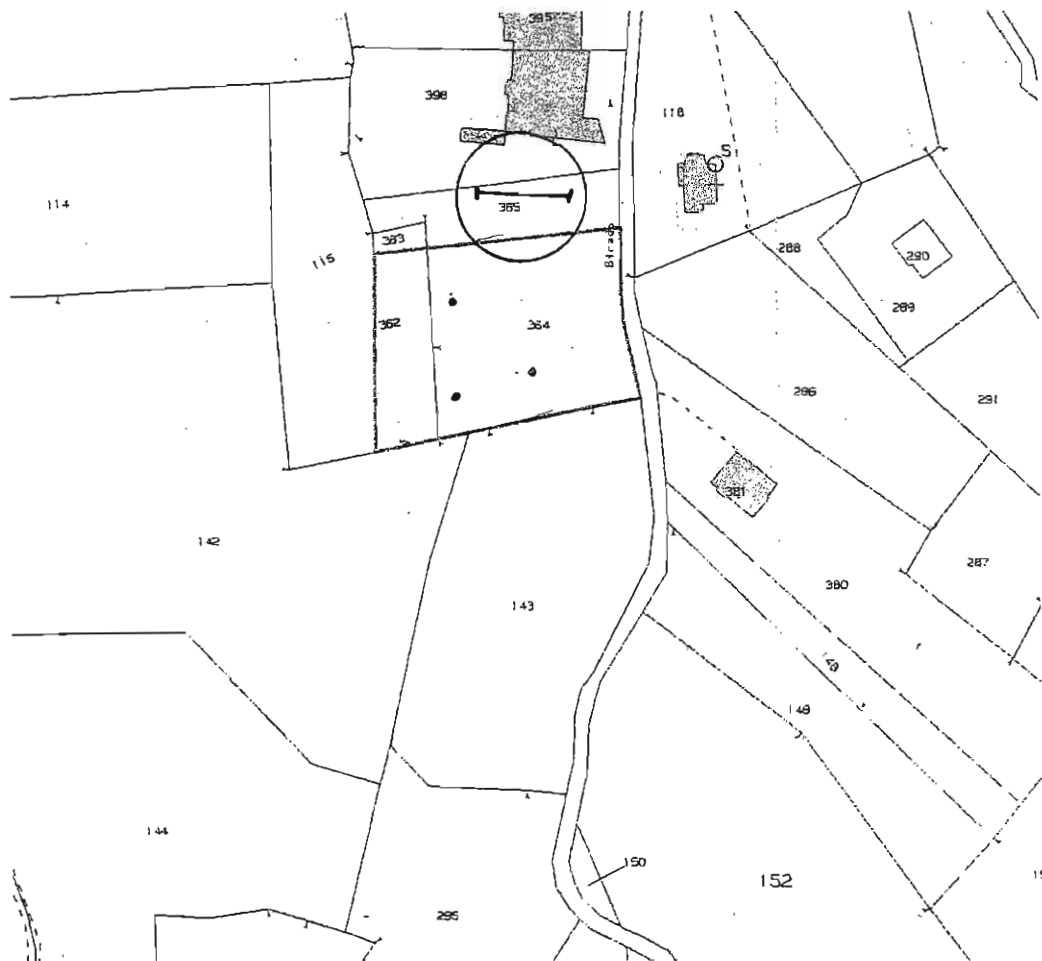

Comune di Baiso

Foglio n°1 MAppali n° 362-364

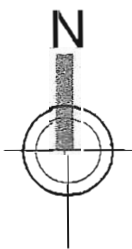

PLANIMETRIA CON UBICAZIONE  
DELLA PROSPEZIONE SISMICA



**DROMOCRONE - Comune di baiso - Località Borgo - CO.IMM s.r.l.**  
Sud Nord

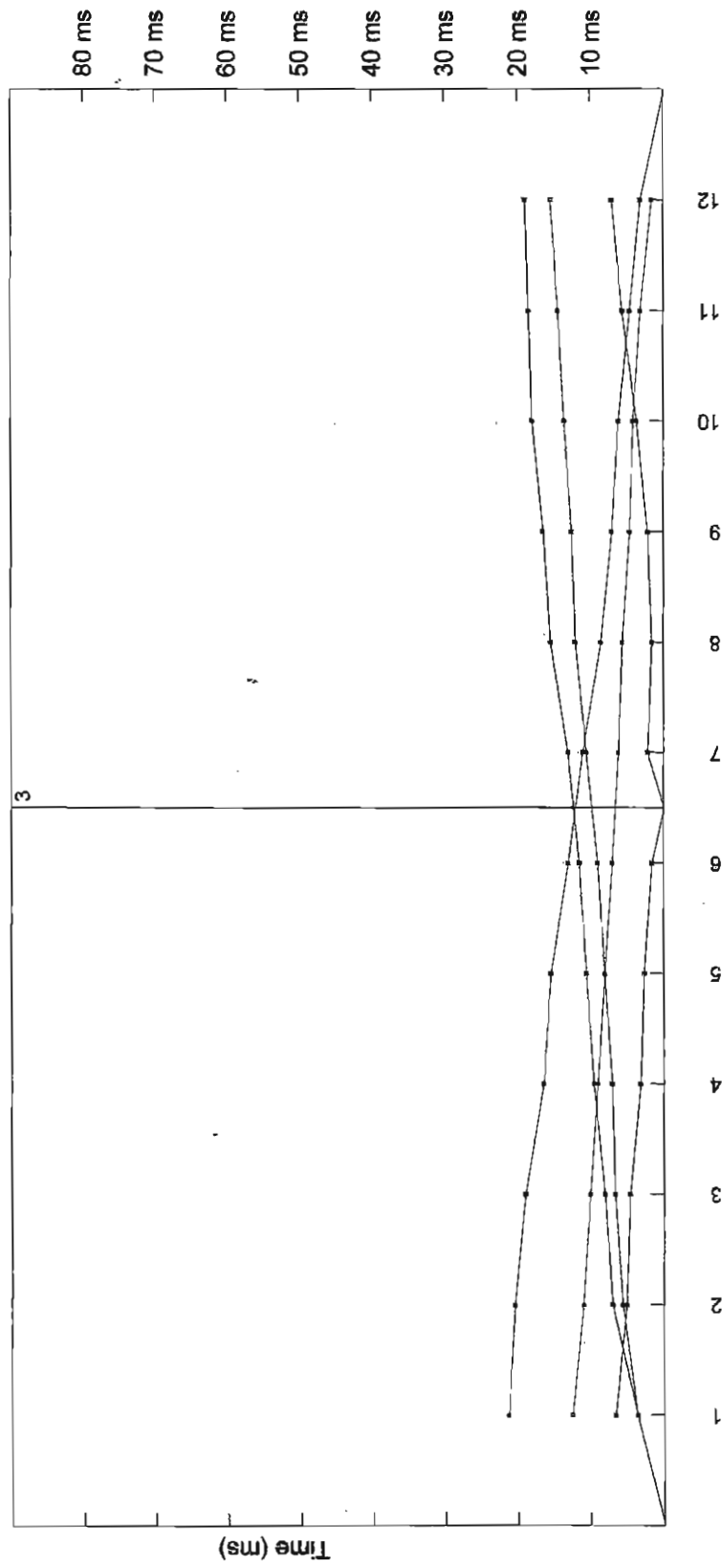

VALORI VELOCITA' ONDE SISMICHE - Comune di baiao - Località Borgo - CO.IMM s.r.l.  
 Sud Nord

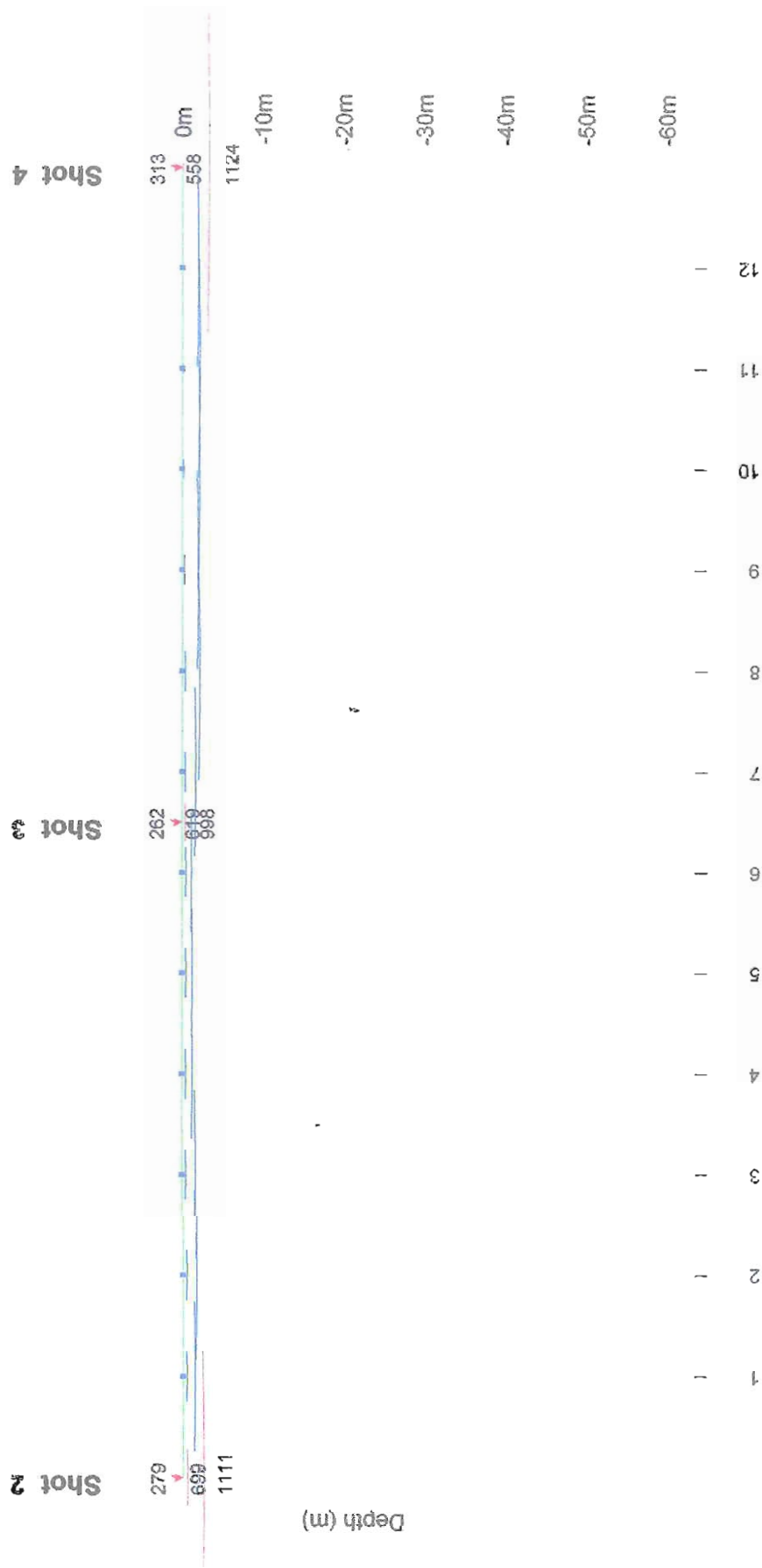

COMUNE DI BAISO - Località BORGIO - CO.IMM s.r.l.

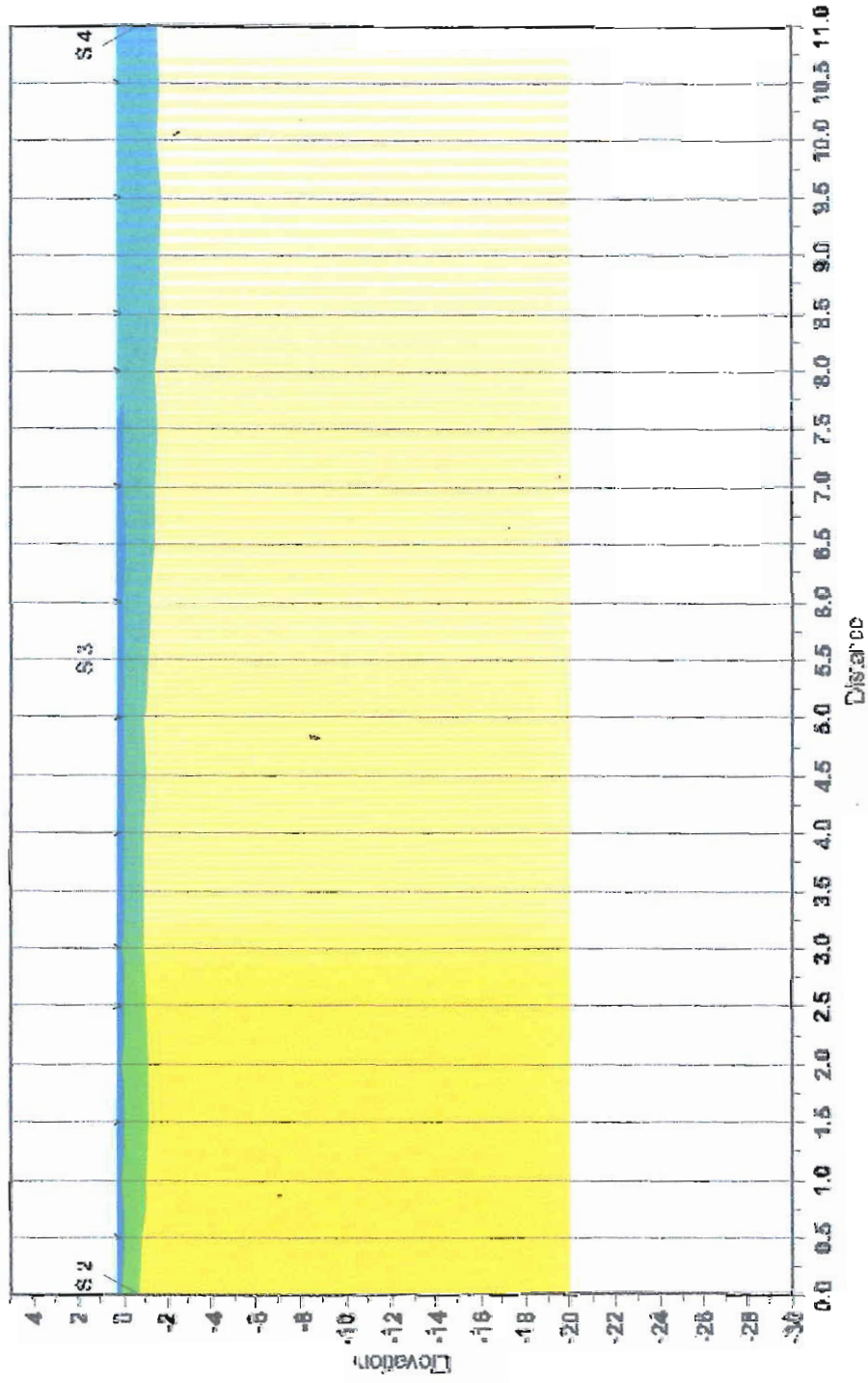

ABC method depth computation